

FORD F-150: 2015-CURRENT

MATERIALS INCLUDED WITH PURCHASE:

- Magnum Headache Rack (1)
- Angled Stake Pocket Tie Downs (2) with required bolts (2) and washers (2)
- Modular Wire Harness (1) - *Only included if you purchased a lighted headache rack*

STEP 1:
Remove side bolt from the stake pocket tie down



STEP 2:
Insert tie down into the stake pocket using the top bolt



(Note: Angled Tie Downs are manufactured specific to driver and passenger side stake pockets - confirm hole for side bolt is facing inside of bed rail toward truck bed)

STEP 3:
While using the top bolt to line up the holes, insert side bolt into tie down through the inside of truck bed



STEP 4:
Align tie down at the top of the stake pocket and tighten side bolt



STEP 5:
Remove the top bolt from the tie down, in preparation for the rack install



Repeat steps 1-5 on the other side of truck

STEP 6:
Align rack evenly on both bed rails (if bed rail has plastic liner, rack foot must be aligned fully on plastic, NO OVERHANG).

Insert top bolt through rack foot into the stake pocket and hand tighten



STEP 7:
Tighten top bolts on both rack feet

⚠ WARNING:
Tighten bolts to secure rack but do not over-torque



If you purchased a lighted headache rack, proceed to page 2

We recommend retightening bolts (including clamp bolts where applicable) within the first week of installation. Video and instructions can be found at <https://magnumtruckracks.com/installation>.

⚠ WARNING: DO NOT EXCEED CAPABILITIES OF TRUCK WHEN HAULING CARGO ON THIS RACK. FOR HEAVY DUTY USE, WE HIGHLY RECOMMEND ADDITIONAL BOLTS ALONG WITH THE STAKE POCKET INSTALLATION.

MODULAR WIRE HARNESS

TAIL LIGHT/BODY CONNECTION HARNESS INSTALLATION

STEP 1:

Feed headache rack wire harness down between cab and bed of truck



STEP 4:

Attach modular wire harness to tail light/body connection port and re-attach plug from Step 3 to the second port on modular wire harness



STEP 2:

At rear of truck, locate and remove bolt for ground wire and attach ground wire from modular wire harness and re-tighten bolt to secure to truck.

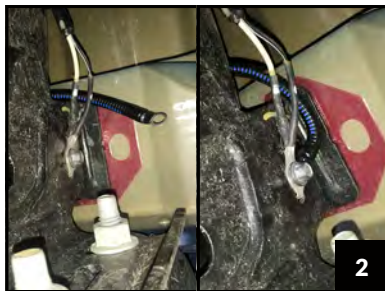

STEP 5:

Run modular wire harness to front of truck and attach to headache rack wire harness



⚠ WARNING:

Magnum recommends using a ratchet and socket to remove and re-insert bolt to truck. Using motorized tools could lead to stripping of bolt and inability to secure bolt.

STEP 3:

At rear of truck, locate and unplug tail light harness/body connection

- Located on driver side by spare tire



STEP 6:

Secure remaining loose/hanging wires to truck using zip-ties and electrical tape

⚠ WARNING:

Chase wire and secure in areas to avoid pinching, splicing, overheating, and any potential moving parts under or around underside of truck frame



We recommend retightening bolts (including clamp bolts where applicable) within the first week of installation. Video and instructions can be found at <https://magnumtruckracks.com/installation>.

⚠ WARNING: DO NOT EXCEED CAPABILITIES OF TRUCK WHEN HAULING CARGO ON THIS RACK. FOR HEAVY DUTY USE, WE HIGHLY RECOMMEND ADDITIONAL BOLTS ALONG WITH THE STAKE POCKET INSTALLATION.